

Product Usage Guide

Professional

BB121-2



**Automatic
Glasswashing
Machines**

**Recommended
Treatment:
Once a month**

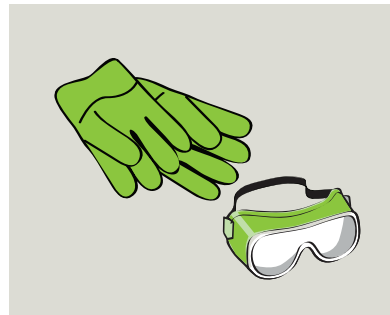

1 Use appropriate PPE as indicated in COSHH/REACH data.



2 Exchange current glasswash detergent for Jangro Glass Renovator.



3 Dilute 1-3ml detergent per litre of water.

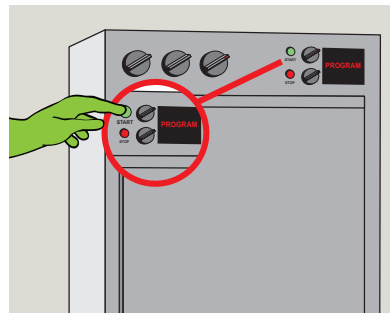

4 Select program and press start.



5 Return to Jangro Glasswash Detergent when all glassware is renovated.

Health & Safety

Please refer to relevant COSHH Safety Data Sheet



Scan for further product details



Not to be used for manual glasswashing.

www.jangro.net